

N° d'art. M102118

Embout de terminaison

Caractéristiques

- A bout lisse
- Pour l'électrosoudage ou le soudage bout à bout
- Pour eau 16 bar / gaz 5 bar
- PE 100

Classification

eClass 12.0 22-56-02-07

eClass 11.0 22-56-02-07

eClass 10.1 22-56-02-07

UNSPSC 11.2 40142315



N° d'art.	Prix brut	d mm	z mm	L mm	e mm	Série	Pression nominale max. bar	CAN N° (ancien)	CAN N° (nouveau)	Code +GF+
10073401 357.320.100	6.60 / pce	20	52	52	3.0	5	16			753.961.006
10073402 357.320.110	6.90 / pce	25	52	52	3.0	5	16			753.961.007
10073403 357.320.120	9.10 / pce	32	54	54	3.0	5	16	425112	425111	753.961.008
10073404 357.320.130	10.10 / pce	40	57	57	3.7	5	16	425113	425112	753.961.009
10073405 357.320.140	13.70 / pce	50	63	63	4.6	5	16	425114	425113	753.961.010
10073406 357.320.150	18.90 / pce	63	65	65	5.8	5	16	425115	425114	753.961.011
10073407 357.320.160	27.40 / pce	75	80	72	6.8	5	16	425116	425115	753.961.012
10073408 357.320.170	41.70 / pce	90	90	81	8.2	5	16	425117	425116	753.961.013
10073409 357.320.180	52.00 / pce	110	98	86	10.0	5	16	425118	425117	753.961.014
10073410 357.320.190	60.00 / pce	125	105	92	11.4	5	16	425119	425118	753.961.015
10085875 357.320.195	76.00 / pce	140	136	92	12.7	5	16	425121	425121	753.961.016
10073411 357.320.200	79.00 / pce	160	120	102	14.6	5	16	425122	425122	753.961.017
10073412 357.320.210	104.00 / pce	180	128	107	16.4	5	16	425123	425123	753.961.018
10073413 357.320.220	133.00 / pce	200	138	115	18.2	5	16	425124	425124	753.961.019
10073414 357.320.230	157.00 / pce	225	148	122	20.5	5	16	425125	425125	753.961.020
10085876 357.320.240	215.00 / pce	250	205	130	22.7	5	16	425126	425126	753.961.021
10085877 357.320.250	301.00 / pce	280	235	139	25.4	5	16	425127	425127	753.960.922
10085878 357.320.260	405.00 / pce	315	255	150	28.6	5	16	425128	425128	753.960.923
10231674 357.320.270	686.00 / pce	355	280	165	32.3	5	16			753.960.924
10231675 357.320.280	1210.00 / pce	400	310	180	36.4	5	16			753.960.925
10085879 357.320.500	41.70 / pce	90	90	81	5.4	8	10	425117	425116	753.960.813



N° d'art.	Prix brut	d mm	z mm	L mm	e mm	Série	Pression nominale max. bar	CAN N° (ancien)	CAN N° (nouveau)	Code +GF+
10085880 357.320.510	55.00 / pce	110	98	86	6.6	8	10	425118	425117	753.960.814
10085881 357.320.520	62.00 / pce	125	105	92	7.4	8	10	425119	425118	753.960.815
10085885 357.320.530	76.00 / pce	140	136	92	8.3	8	10	425121	425121	753.960.816
10085882 357.320.540	84.00 / pce	160	120	102	9.5	8	10	425122	425122	753.960.817
10085883 357.320.550	101.00 / pce	180	128	107	10.7	8	10	425123	425123	753.960.818
10085884 357.320.560	133.00 / pce	200	138	115	11.9	8	10	425124	425124	753.960.819
10085886 357.320.570	157.00 / pce	225	148	122	13.4	8	10	425125	425125	753.960.820
10085887 357.320.580	192.00 / pce	250	205	130	14.8	8	10	425126	425126	753.960.821
10085888 357.320.590	295.00 / pce	280	235	139	16.6	8	10	425127	425127	753.960.822
10085889 357.320.600	386.00 / pce	315	255	150	18.7	8	10	425128	425128	753.960.823
10231676 357.320.610	686.00 / pce	355	280	165	21.1	8	10			753.960.824
10231677 357.320.620	1210.00 / pce	400	310	180	23.7	8	10			753.960.825

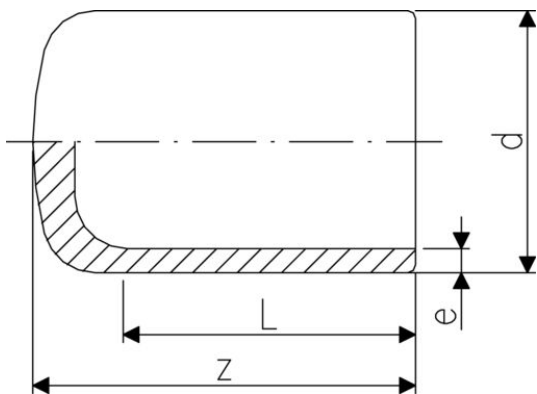

Prix en CHF. Les prix ont valeur indicative, sans engagement. Livraisons uniquement en Suisse et au Liechtenstein.

