

N° d'art. M105286

+GF+ Type 330

Raccord fileté en fonte malléable

Caractéristiques

- À joint plat
- Avec filetage femelle

Données techniques

ISO / EN U1

Surface Zingué

N° SSIGE eau 7912-786

N° SSIGE gaz 99-086-6

Classification

UNSPSC 11.2 40142315

eClass 12.0 22-56-02-11

eClass 10.1 22-56-02-11

eClass 11.0 22-56-02-11

Informations complémentaires



| N° d'art. | UE | Prix brut | Dimensions " | 374 G " | a mm | z1 mm | s1 mm | s2 mm | s3 mm | N° CAN | Code +GF+ |
|-------------------------|--------|--------------|-----------------|------------|---------|----------|----------|----------|----------|--------|-------------|
| 10021545 531.520.110 | 60 pce | 23.50 / pce | 1/4" | 5/8 | 42 | 22 | 19 | 28 | 10 | | 770.330.202 |
| 10021546 531.520.120 | 40 pce | 13.70 / pce | 3/8" | 3/4 | 47 | 27 | 22 | 32 | 12 | 225111 | 770.330.203 |
| 10021547 531.520.130 | 70 pce | 8.20 / pce | 1/2" | 1 | 48 | 22 | 26 | 41 | 26 | 225112 | 770.330.204 |
| 10021548 531.520.140 | 50 pce | 9.60 / pce | 3/4" | 1 1/4 | 52 | 22 | 31 | 48 | 31 | 225113 | 770.330.205 |
| 10021549 531.520.150 | 30 pce | 11.30 / pce | 1" | 1 1/2 | 59 | 25 | 38 | 55 | 38 | 225114 | 770.330.206 |
| 10021550 531.520.160 | 20 pce | 19.10 / pce | 1 1/4" | 2 | 65 | 27 | 48 | 67 | 48 | 225115 | 770.330.207 |
| 10021551 531.520.170 | 15 pce | 24.40 / pce | 1 1/2" | 2 1/4 | 70 | 32 | 54 | 74 | 54 | 225116 | 770.330.208 |
| 10021552 531.520.180 | 10 pce | 40.70 / pce | 2" | 2 3/4 | 80 | 32 | 66 | 90 | 67 | 225117 | 770.330.209 |
| 10021553 531.520.190 | 5 pce | 126.00 / pce | 2 1/2" | 3 1/2 | 85 | 31 | 85 | 111 | 85 | 225118 | 770.330.210 |
| 10021554 531.520.200 | 8 pce | 206.00 / pce | 3" | 4 | 96 | 36 | 96 | 130 | 96 | 215121 | 770.330.211 |
| 10021555 531.520.210 | 4 pce | 484.00 / pce | 4" | 5 | 111 | 39 | 120 | 151 | 122 | 215122 | 770.330.212 |



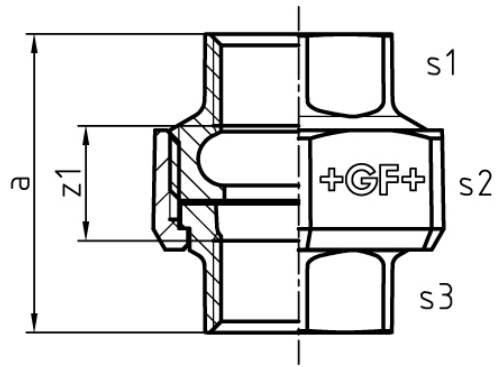

Prix en CHF. Les prix ont valeur indicative, sans engagement. Livraisons uniquement en Suisse et au Liechtenstein.

